

# Overview of the main fittings

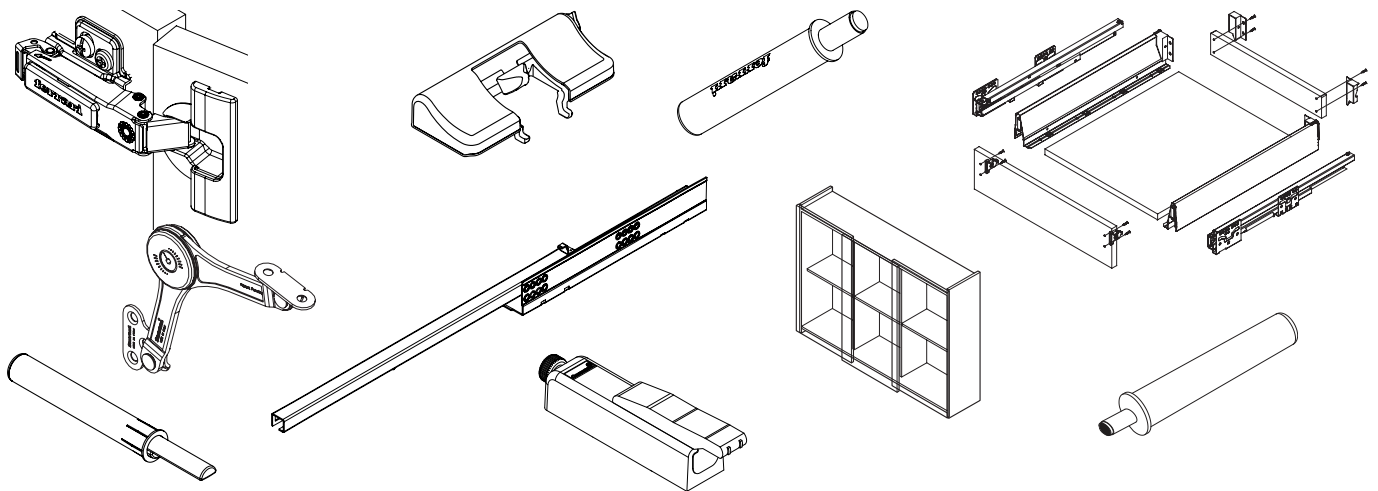



# Index

4 Company

6 The Hinges

7 Slide-on hinges

8 Anyway clip hinges

9 The plates

10 Harmony, the soft closing hinge

12 Door dampers

14 Magic touch latches

16 Klok

18 Akrobat

20 Elite sliding door fitting

22 F-1 Box: the double wall drawer

24 Undermount drawer slides

36 Ball Bearing drawer slides

38 Roller drawer slides

Company

Hinges

Dampers

Magic

Stays

Elite

Drawers

Slides

## Furniture hinges on Ferrari

Ferrari was founded in Lecco (Italy) in 1947 and since then the production of furniture hinges and accessories has continued.

The long experience in this industry helped to develop modern products with a high level of technology, all of which are internationally patented.

Innovation, dedication and enthusiasm have strongly characterised the company personality, resulting in a global growth that makes Ferrari active in over 70 countries.

This fast expansion created a need to move the company in 2001 to the new headquarters in Verderio S. (LC), where Ferrari has more room and modern facilities.

Ferrari has directed the technologic evolution of the furniture industry starting from the piano hinge until the modern concealed hinges, expanding the product range including the lid stays, drawers, drawer slides, sliding door fittings, fittings and other furniture accessories.

Today Ferrari is experience, know-how, quality and internationally awarded design made in Italy.

## Ferrari, a modern, dynamic, international enterprise



Ferrari S.p.A.  
Italy



Ferrari America, Inc.  
USA



Ferrari Shunde  
China

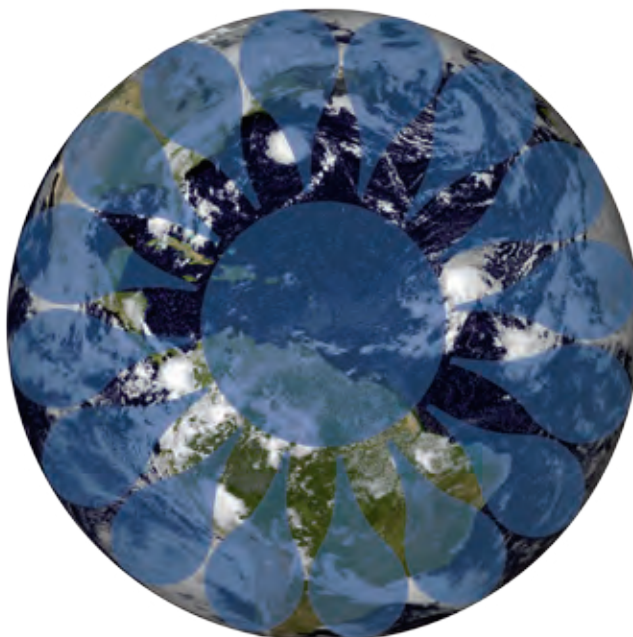

Ferrari Germany, GmbH  
Germany



Ferrari Sk, s.r.o.  
Slovakia

## Ferrari & Quality

Ferrari is strongly committed to quality, as it is well aware that it is the key to satisfy end users and furniture manufacturers.

Ferrari implements strict Quality Control Programs in all manufacturing processes regulated by internal procedures, from the raw materials to finished products, to manufacture high quality products.

Ferrari has the UNI EN ISO 9001 Certification since 1997 and the UNI EN ISO 14001 Certification since 2003.

Ferrari sends the products periodically to International Institutions from several countries (Italy, Germany, USA, United Kingdom, France, Spain), in order to carry out independent tests to confirm the qualification of “supplier of high quality fittings”.



The Ferrari brand portfolio



Furniture fittings: concealed hinges, stays, drawers, drawer slides and sliding door fittings.



Zamak die casting, die manufacturing.



Production and distribution of quality furniture fittings.



The whole Ferrari product range is also available under the IC Ferrari brand. The IC Ferrari ECO line provides quality at affordable prices.

## Ferrari Hinges



Slide-on



Anyway Clip

## Ferrari hinges

Ferrari manufactures high quality hinges since 1947.

Over 60 years of manufacturing mean experience, expertise, know-how, reliability and quality.

The product range includes the slide-on and clip-on versions, according to the customer needs.

The “Slide-on” version is easily mounted with a simple sliding motion, while the “Anyway Clip” version is the best clip-on hinge system available on the market.

The Ferrari hinges are also easy to mount, with quick fastening system “Speed”



Digit

Speed

## The slide-on hinges



Slide-on

### Slide-on series

The slide-on hinges are mounted with a simple sliding movement.

The hinge is designed in a way to enable the optimal hinge mounting in any possible adjustment.

The hinge is available with cup and arm covers. More customized accessories are available upon request.

Available openings: 95°, 110°, 125°, 165° 170°.

The product range includes applications for wooden doors, aluminium profiles and glass doors.



## Anyway clip hinges

Anyway clip



### Anyway Clip

Hinges provided with an innovative, easy and safe metal release. The clip-on mechanism doesn't require any specific positioning of the hinge: the hinge can be clipped on the plate in any direction. The plates are reversible.

Such characteristics permit maximum ease in mounting and installing even with large/tall doors that require the use of more hinges.

Automatic or manual door adjustment system.

Absolute safety against any accidental release.

Available openings: 95°, 110°, 125°, 165° 170°.

The product range includes applications for wooden doors, aluminium profiles and glass doors.

Anyway Clip 91 are provided with a cam for the frontal adjustment (U.S. Patent: 5.781.966).

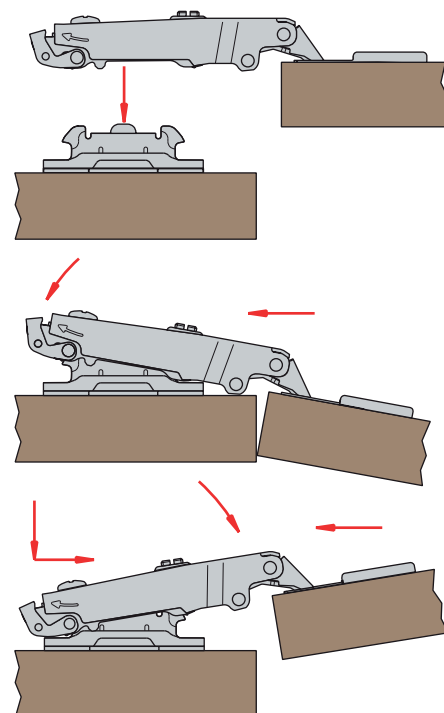

## Compasso

The first plate that allows any door angle inclination with standard fixing positions. This plate is available only for slide-on hinges. Adjustment from 5° to 22°

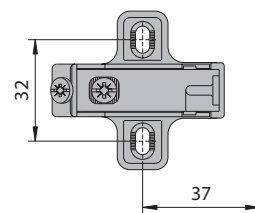
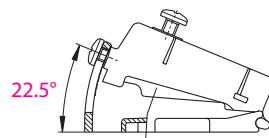
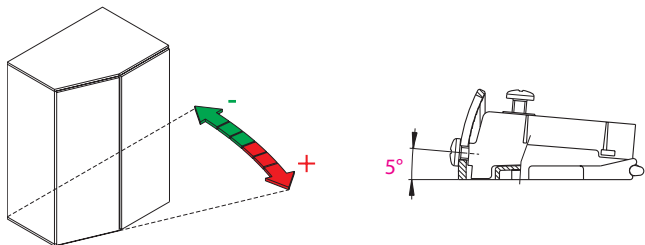

## Pilot

Symmetrical & reversible mounting plate with patented cam for an easy vertical adjustment ( $\pm 1.5$  mm). Vertical & parallel adjustment is possible simply using the cam. Available for Anyway Clip hinges only.

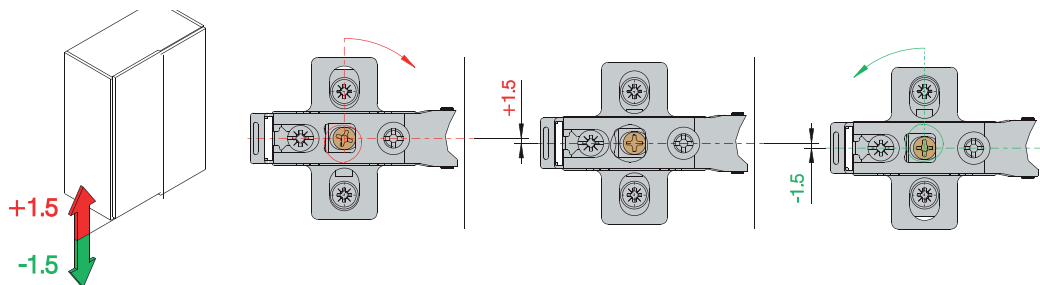

## New adjustable Pilot plate made of iron

New reversible clip plate made of metal to reduce costs.

This plate is vertically adjustable ( $\pm 2$  mm)

Available for slide-on and clip hinges, with premounted euroscrews, 10 Ø mm dowels and self-tapping screws.

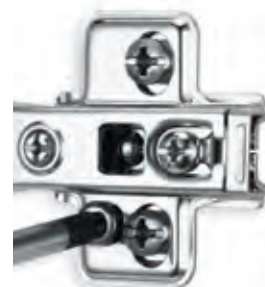
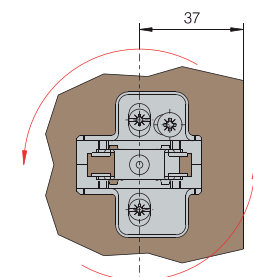
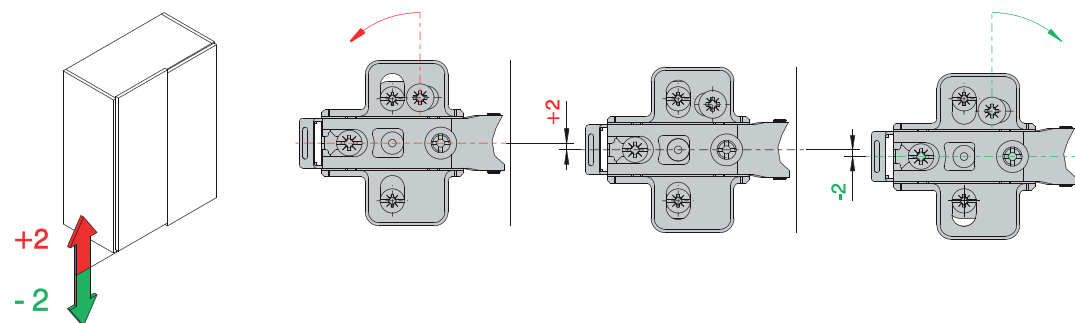

## Harmony - the soft closing hinge

Harmony

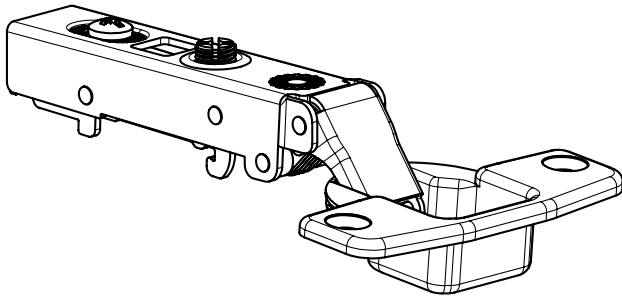

- Different cranks and openings available (30°, 45°, 90°, blind corner and 165°)
- Tested & approved by the Ferrari labs
- Guaranteed up to 50,000 cycles
- Quick fastening available
- Front and vertical cam adjustment plates available

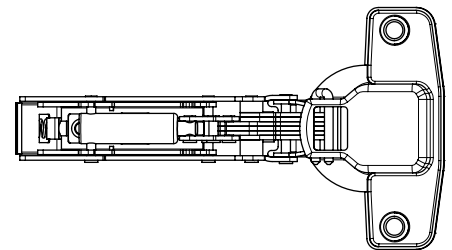
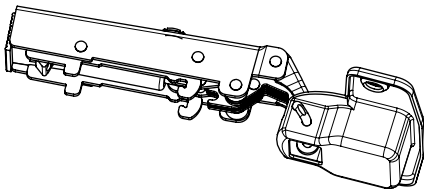
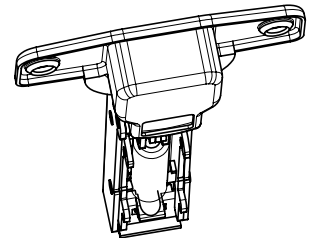
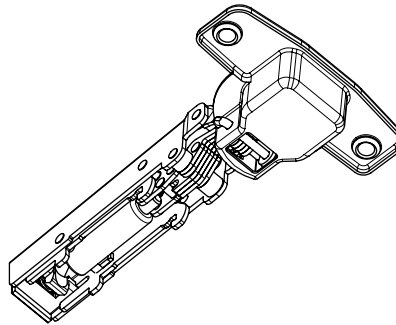
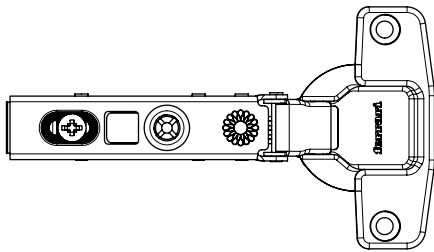



## Wave



## Wave

WAVE is the new soft-closing solution for Ferrari made in Italy hinges.

The damper is mounted directly on the hinge cup.

The quick and safe clip-on system guarantees a satisfactory grip.

Trough the adjustment screw it is possible to reduce the damping effect (-20% by two steps) even after the installation.

Two versions available, one for 0 crank hinges, and one for all other hinges, Wave applies to Ø35 mm hinges 95°/110° opening

This product is tested up to 80,000 cycles.

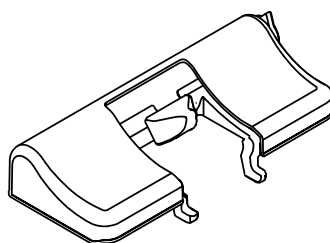

Wave (0 crank hinges only)

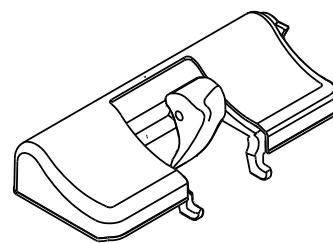

Wave (all cranks)

## Si-softech



## Si-Softech

Si-softech is the best soft-closing solution for any cabinet.

Si-softech applies even to existing cabinets.

Wide range of possible installations.

Suitable for all kinds of hinges.

Easy and quick installation.

The damping force can be adjusted with the screw on the back.

Si-softech is tested and guaranteed up to 100,000 cycles.

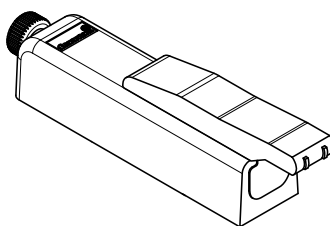

## Airdamp



## Airdamp

Airdamp is an innovative air furniture door damper.

This damper provides excellent soft-closing performances.

Airdamp is normally used in Ø 10 mm holes or with its cross shaped adaptor.

The product is sold in grey finishing.

Airdamp is tested and guaranteed up to 100,000 cycles.

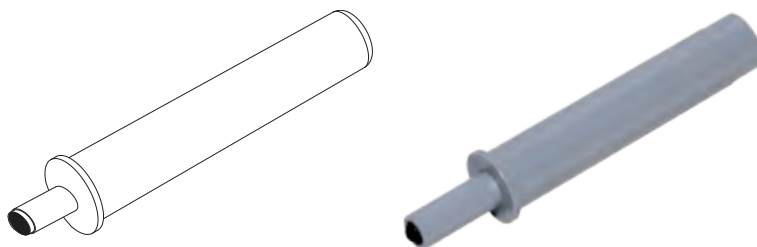

## Flexdamp



## Flexdamp

Flexdamp is an innovative oil furniture door damper.

It provides excellent results in soft closing.

Flexdamp is normally used in Ø 10 mm holes or with its cross-shaped adaptor.

Flexdamp is tested and guaranteed up to 80,000 cycles.

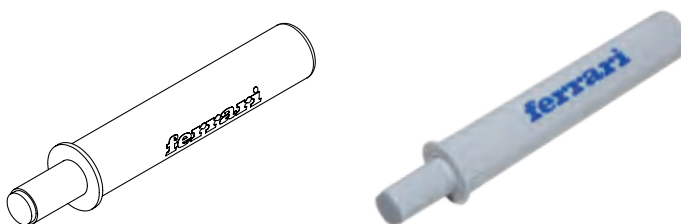

## Magic

Magic is the standard touch latch for  $\varnothing$  10 mm holes

Two versions available:

- standard, with magnet 10 N retaining force.
- adjustable, with 12mm stroke, 3mm adjustment on cup and 15 N magnet

Available also white or black colors.

Several cabinet adaptors are available.

Tested up to 100,000 cycles.

Magic won the “M Technology Award” in 2007.

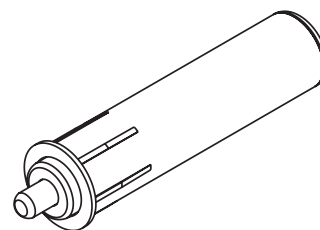

Magic

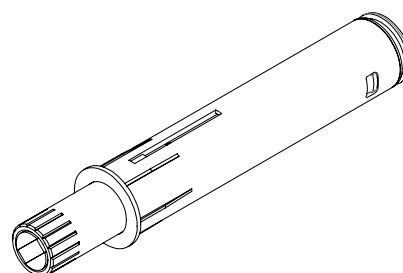

Adjustable Magic

Magic

## XL Magic

XL Magic is the 3mm adjustable touch latch with magnet 15 N retaining force.

XL Magic is available with linear (mm 16+32) and cross shaped (mm 10x32) adaptor

Tested up to 100,000 cycles.

XL Magic is also available in the basic version without adjustment, with cross shaped adaptor.

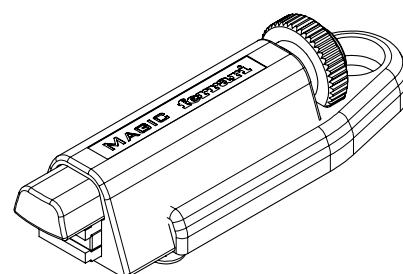

Adjustable XL Magic

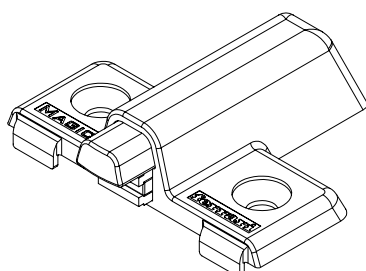

XL Magic

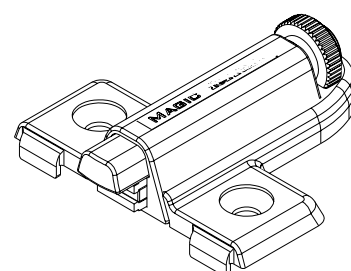

Adjustable XL Magic

## Magic Plus

Magic Plus is the natural evolution of the Magic product range. Its features are:

- Door opens about 25 mm
- It can fit in a Ø 10 mm hole
- It can be used with most of the standard Magic adaptors
- Version with magnet (10 N retaining force) can be used with hinges without spring
- Version without magnet can be used with standard hinge

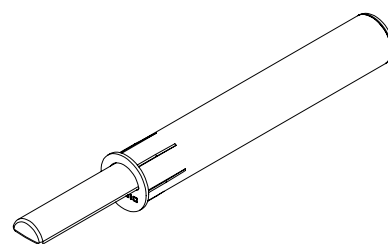

**Magic Plus**

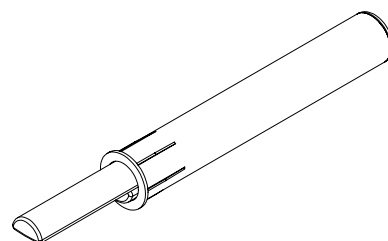

**Magic Plus  
with magnet**

## Maxi Magic

Maxi Magic is the new adjustable touch latch.

- Front adjustment: 5 mm
- Enables a 40 mm door opening
- Case made of metal
- Plate drilling distances: 16+21 and 16+32
- Product available with or without magnet (8N retaining force).

New version available for 10 mm holes:

- 4mm adjustment on cup
- Enables a 40 mm door opening
- Pushing force 30 N to be used for lift-up and drop-down applications
- Several cabinet adaptors are available.
- Product available with or without magnet (15N retaining force)

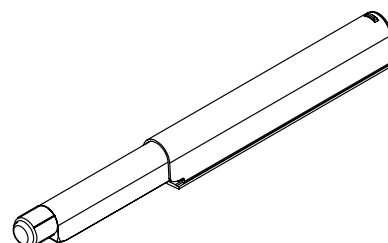

**Maxi Magic**

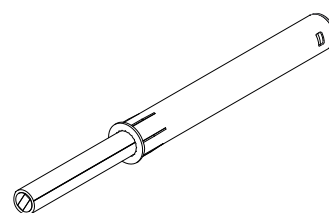

**Adjustable Magic**

## Klok & XL Klok

High strength and load capacity

Precision mechanism to ensure light and smooth action with flap held at any angle

It can be mounted on wooden and aluminium frame flap doors upwards and downwards (1 and 2)

Available in two versions: Klok for light door and XL Klok for large doors

Klok for light doors is available in steel version, which is reversible and can be used both for lift-up and drop-down applications.

Tested for over 100,000 cycles

Guaranteed durability

U.S. Patent US6.504.654

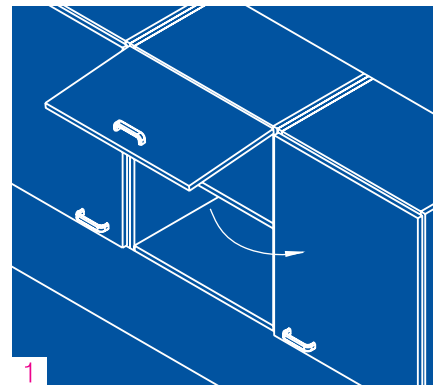

1



intelligent  
material  
and design  
2003

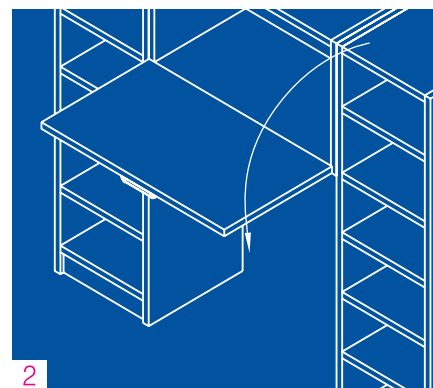

2

Klok

Mounting instruction - lift up

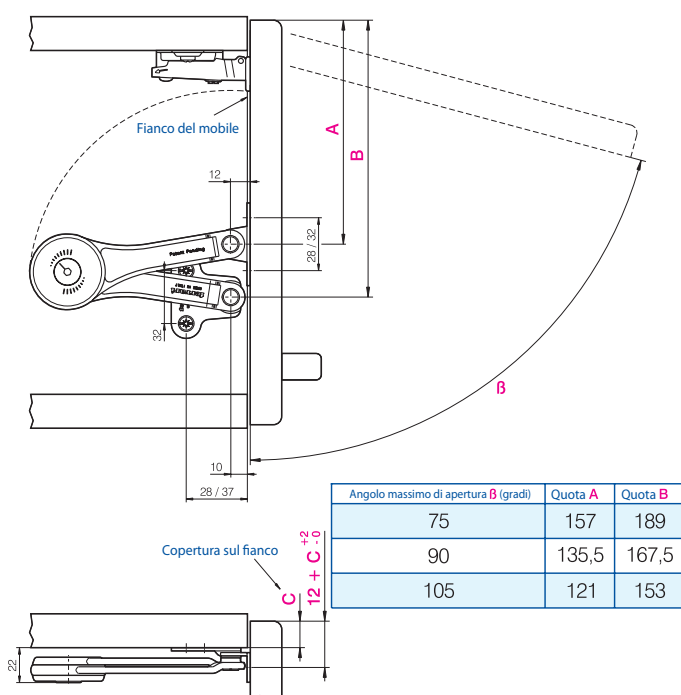

Mounting instruction - drop down

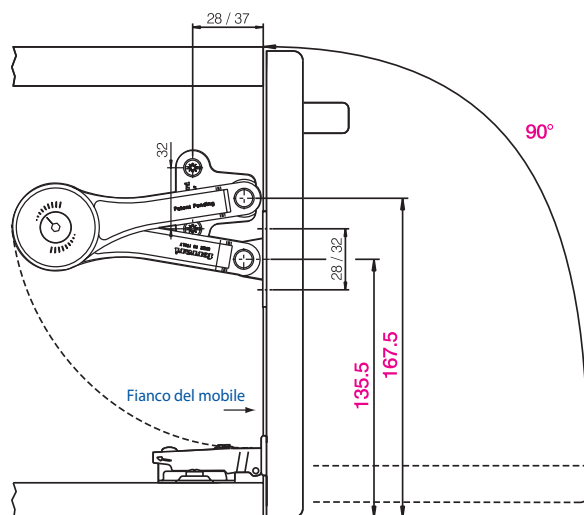

In order to hold the door in any position the number of Klok or XL Klok must be calculated according to the door weight **P**, the door height **H** and the desired maximum opening **B**

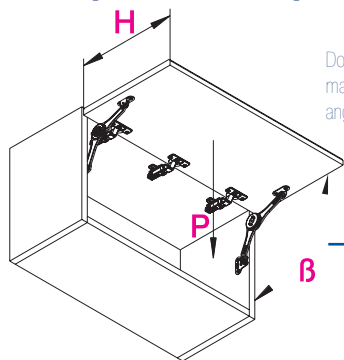

Door weight **P** and maximum opening angle **B**.

Door height **H** in mm

1 x Klok

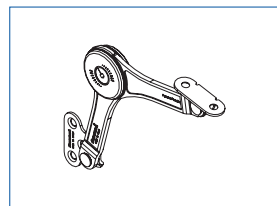

2 x Klok

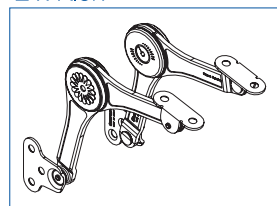

1 x XL Klok

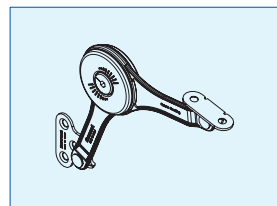

2 x XL Klok

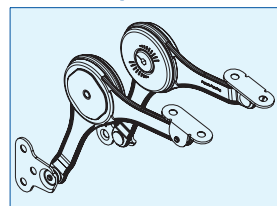

			300		350		400		450		500		550		600		650		700	
			Klok	XL Klok	Klok	XL Klok	Klok	XL Klok	Klok	XL Klok	Klok	XL Klok	Klok	XL Klok	Klok	XL Klok	Klok	XL Klok	Klok	XL Klok
2 Kg	75°		1	/	1	/	1	/	1	/	1	/	1	/	1	/	1	/	1	/
	90°		1	/	1	/	1	/	1	/	1	/	1	/	1	/	1	/	1	/
	105°		1	/	1	/	1	/	1	/	1	/	1	/	1	/	2	/	2	/
3 Kg	75°		1	/	1	/	1	/	1	/	1	/	1	/	1	/	1	/	1	/
	90°		1	/	1	/	1	/	1	/	1	/	2	/	2	/	2	/	2	/
	105°		1	/	1	/	1	/	2	/	2	/	2	/	2	/	2	/	2	/
4 Kg	75°		1	/	1	/	1	/	1	/	1	/	2	/	2	/	2	/	2	/
	90°		1	/	1	/	2	/	2	/	2	/	2	/	2	/	2	/	2	/
	105°		1	/	2	/	2	/	2	/	2	/	2	/	2	/	/	/	/	/
5 Kg	75°		1	1	1	1	1	1	2	1	2	1	2	1	2	1	2	1	2	1
	90°		1	1	2	1	2	1	2	1	2	1	2	1	2	1	/	2	/	2
	105°		2	1	2	1	2	1	2	1	/	2	/	2	/	2	/	2	/	2
6 Kg	75°		1	1	1	1	2	1	2	1	2	1	2	1	2	1	2	1	2	1
	90°		2	1	2	1	2	1	2	1	2	1	/	2	/	2	/	2	/	2
	105°		2	1	2	1	2	1	/	2	/	2	/	2	/	2	/	2	/	2
7 Kg	75°		1	1	2	1	2	1	2	1	2	1	2	1	2	1	/	2	/	2
	90°		2	1	2	1	2	1	/	2	/	2	/	2	/	2	/	2	/	2
	105°		2	1	/	2	/	2	/	2	/	2	/	2	/	2	/	2	/	/
8 Kg	75°		2	1	2	1	2	1	2	1	2	1	/	2	/	2	/	2	/	2
	90°		2	1	2	1	/	2	/	2	/	2	/	2	/	2	/	2	/	2
	105°		2	1	/	2	/	2	/	2	/	2	/	2	/	2	/	/	/	/
9 Kg	75°		/	1	/	1	/	1	/	1	/	2	/	2	/	2	/	2	/	2
	90°		/	1	/	2	/	2	/	2	/	2	/	2	/	2	/	2	/	/
	105°		/	2	/	2	/	2	/	2	/	2	/	/	/	/	/	/	/	/
10 Kg	75°		/	1	/	1	/	1	/	2	/	2	/	2	/	2	/	2	/	2
	90°		/	1	/	2	/	2	/	2	/	2	/	2	/	2	/	/	/	/
	105°		/	2	/	2	/	2	/	2	/	/	/	/	/	/	/	/	/	/
11 Kg	75°		/	1	/	1	/	2	/	2	/	2	/	2	/	2	/	2	/	2
	90°		/	2	/	2	/	2	/	2	/	2	/	/	/	/	/	/	/	/
	105°		/	2	/	2	/	2	/	/	/	/	/	/	/	/	/	/	/	/
12 Kg	75°		/	1	/	1	/	2	/	2	/	2	/	2	/	2	/	2	/	2
	90°		/	2	/	2	/	2	/	2	/	2	/	/	/	/	/	/	/	/
	105°		/	2	/	2	/	2	/	/	/	/	/	/	/	/	/	/	/	/

Akrobat



## The gas lift

- Universal mechanism with special “clip-on” adapter plates
- Available for wood and/or aluminium doors
- Available with “stay open” and “stay close” features
- Effortless opening of doors and lids
- Secure holding in open and closed positions
- Smooth motion and stopping
- Available with several “recall” forces
- Easy to mount/install
- Compact and attractive design
- Maintenance free
- Metal gray finish

Universal adaptor plate for wooden doors 28/32

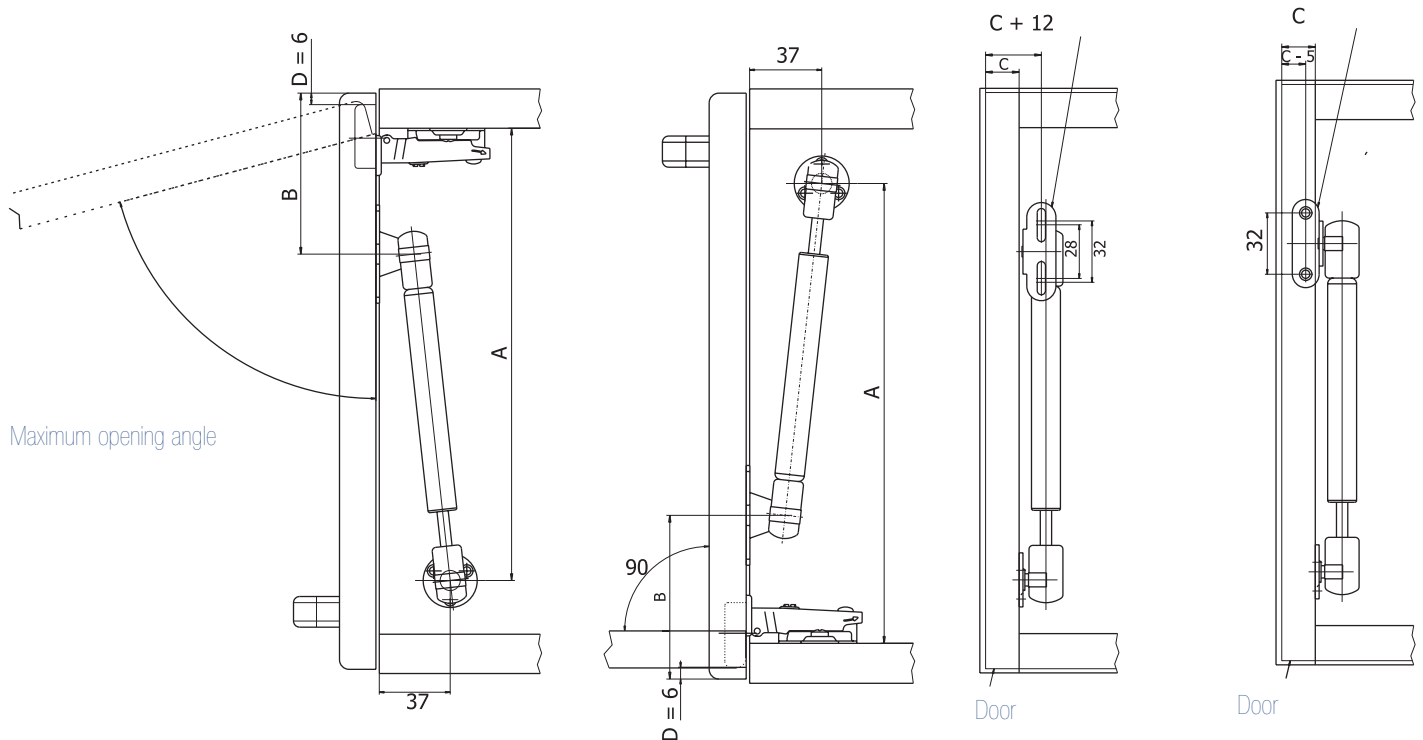

### Lift-up applications

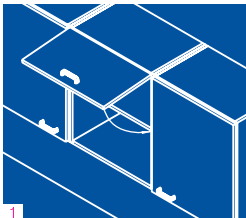
	L	Maximum opening angle	A	B
	243	75°	257.5	84
	243	90°	236	84
	243	105°	221	76
	276	75°	291	100
	276	90°	265	100
	276	105°	252	84

### Drop-down applications

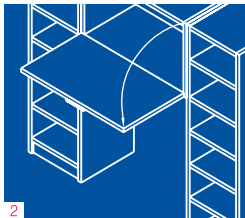
	L	Maximum opening angle	A	B
	243	90°	236	84

# Akrobat gas Lift Technical Sheet

## Number and type of lifts

Door Wgt	Door hgt	mm 300			mm 350			mm 400			mm 450			mm 500			mm 550			mm 600			mm 650			mm 700		
	Lift force (N)	60	80	100	60	80	100	60	80	100	60	80	100	60	80	100	60	80	100	60	80	100	60	80	100	60	80	100
	Opening angle																											
Kg 2	75°																											
	90°	1	x	x	1	x	x	1	x	x	1	x	x	1	x	x	1	x	x	2	x	x	2	1	x	2	x	x
	100°	1	x	x	1	x	x	1	x	x	1	x	x	1	x	x	2	1	x	2	1	x	2	1	x	2	2	1
Kg 3	75°																											
	90°	1	x	x	1	x	x	2	x	x	2	1	x	2	2	x	2	2	1	2	2	2	2	2	2	x	2	2
	100°	1	x	x	2	x	x	2	1	x	2	2	x	2	2	1	2	2	2	x	2	2	x	2	2	x	2	2
Kg 4	75°																											
	90°	2	x	x	2	1	x	2	2	1	2	2	1	x	2	2	x	2	2	x	2	2	x	2	2	x	x	2
	100°	2	1	x	2	2	1	2	2	1	x	2	2	x	2	2	x	2	2	x	x	2	x	x	2	x	x	2
Kg 5	75°																											
	90°	2	1	x	2	2	1	x	2	2	x	2	2	x	2	2	x	2	2	x	x	2	x	x	2			
	100°	2	2	1	x	2	2	x	2	2	x	2	2	x	x	2	x	x	2	x	x	x						
Kg 6	75°																											
	90°	2	2	1	x	2	2	x	2	2	x	x	2	x	x	2												
	100°	x	2	1	x	2	2	x	x	2	x	x	2	x	x	x												
Kg 7	75°																											
	90°	x	2	2	x	2	2	x	x	2	x	x	2															
	100°	x	2	2	x	x	2	x	x	2	x	x	x															
Kg 8	75°																											
	90°	x	2	2	x	x	2																					
	100°	x	x	2	x	x	2																					
Kg 9	75°																											
	90°	x	2	2	x	x	2																					
	100°	x	x	2																								

This chart is intended merely as a general guidance. It is based on approximations and therefore in some cases it may not be coherent with real cases. "x" means that the lift is not suitable.

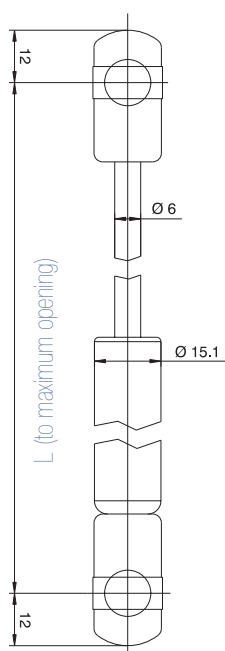

Lift-up applications		
L	Force (N)	Kit code (containing : gas lift, cabinet plate, door plate for wooden and aluminium door, 7 screws)
243	60	PGA243C060AK001
243	80	PGA243C080AK002
243	100	PGA243C100AK003
276	60	PGA276C060AK004
276	80	PGA276C060AK005
276	100	PGA276C060AK006
Drop-down applications		
243	40	PGC243C060AK007

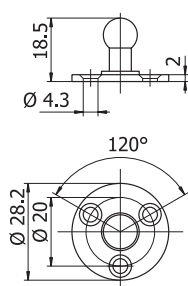

Universal cabinet adaptor plate for surface mounting

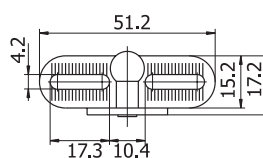

Universal cabinet adaptor plate for wooden doors

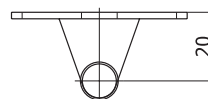

Universal cabinet adaptor plate for aluminium doors

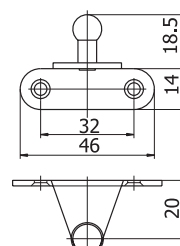

Elite



## Sliding door fitting

- Easy mounting from top to bottom
- New soft-closing system, mounted directly on the door
- Smooth and silent sliding
- Easily adjustable
- Patented no-derail safety feature
- Available 2 & 3 doors versions
- Load capacity 80 Kg
- Door thickness up to 50mm
- 100% Italian Design

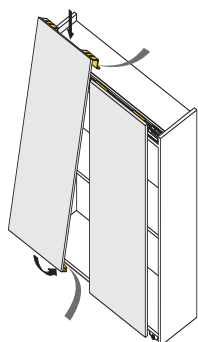

Easy mounting from top to bottom

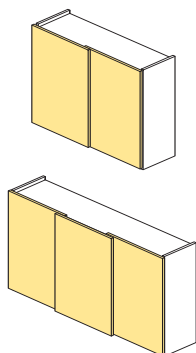

Available for 2 & 3 doors applications

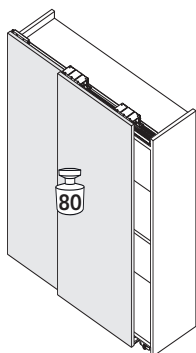

Load capacity 80 kg



Extremely silent mechanism



Patented "no-derail" safety feature



100% Italian design



New double effect damper, an optional soft-closing system with excellent performance.

The damping system is mounted directly on the door, and allows a smooth and silent soft closing in both directions.

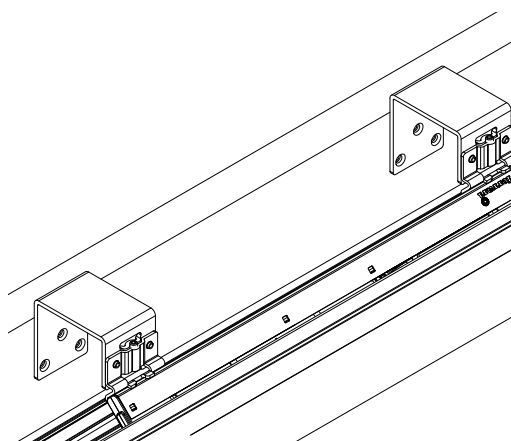
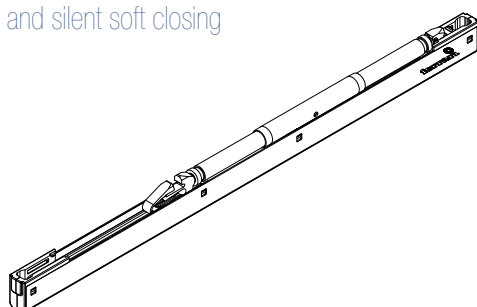

## F-1 Box: the Double Wall Drawer

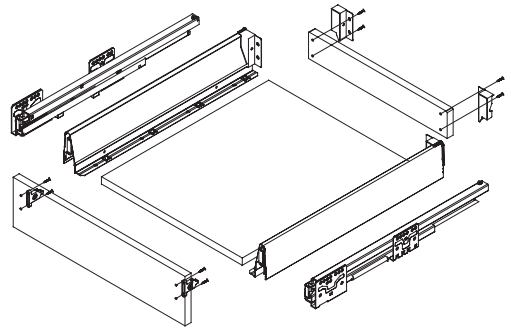
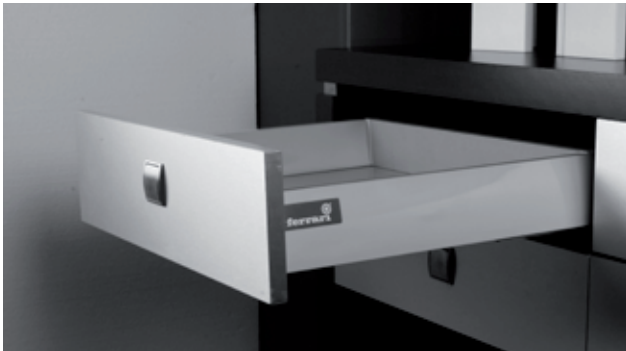

### Product Characteristics

- Extremely silent, stable, and smooth mechanism
- Available lengths: mm 270, 300, 350, 400, 450, 500, 550
- 86 mm high side plate made of gray steel RAL 7045 or, upon request, silver gray steel RAL 9006, white RAL 9010, cream RAL 9001 or black RAL 9005
- Inner drawers also available
- Railing available for mm 160 & 200 heights
- Vertical drawer adjustment  $\pm 2$  mm; horizontal drawer adjustment  $\pm 1$  mm
- Quick assembling and dismantling
- Concealed full extension runners with 40 kg load capacity
- Tested up to 80,000 cycles
- New built-in self-closing soft closing mechanisms
- Product range includes railing, double-layer heightened side plates, and more accessories



Vertical drawer adjustment  $\pm 2$  mm



Horizontal drawer adjustment  $\pm 1$  mm



Railing available for mm 145 & 185 heights

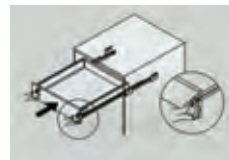

Quick & easy assembly



Built-in soft-closing system

## F-1 Box: the Double Wall Drawer



A wide range of accessories are available

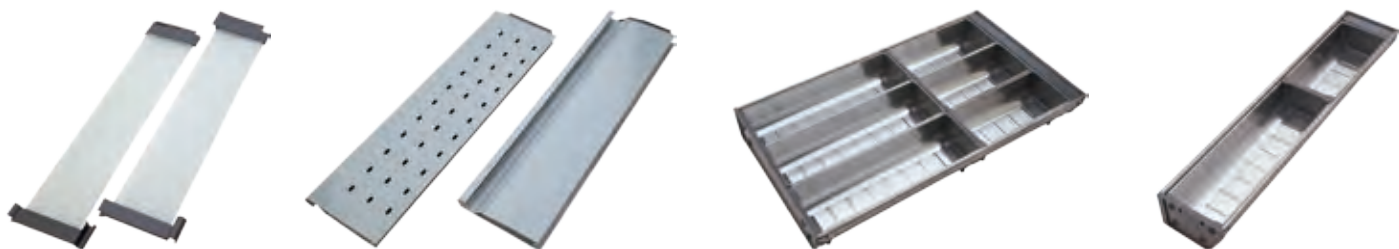

## Undermount drawer slides

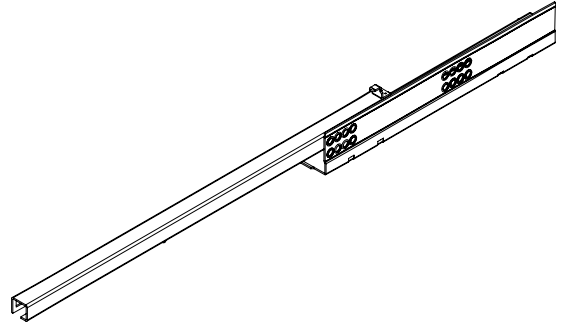

### Product Characteristics

- Extremely silent and smooth sliding
- Very stable mechanism
- Vertical drawer adjustment
- Self-closing & soft-closing systems available
- Single and full extension versions available
- Load capacity 25Kg
- Available length: mm 300, 350, 400, 450, 500 & 550 - 12, 15, 18, & 21 inch



Soft-closing version available



Quick release system



Built-in self-closing



Available full & partial extension versions

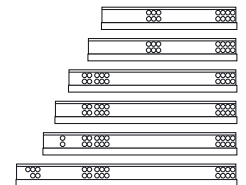

Available lengths: mm 300, 350, 400, 450, 500, and 550  
12, 15, 18, & 21 inch

## Undermount drawer slides

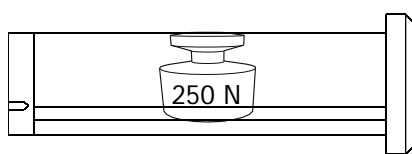

Load capacity: 25Kg

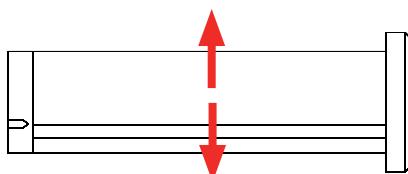

Vertical drawer adjustment 0/+2 mm



Frame version available

## Ball bearing slides h 45 mm, full extension soft closing and push-to-open



Cabinet profile and drawer profile must be separated when mounting.  
Expand slide, place it on its side and pull black lever as shown in order to separate the profiles.  
Slide the two profiles into the respective wood parts.  
Mount the drawer by inserting profiles inside one another.

- Mounting on drawer side
- Separable cabinet and drawer profiles for mounting
- Guiding double tracks, stop in opening
- Load capacity 25 kg per set (soft closing),  
45 Kg per set (push-to-open)

Drawer lengths	Code Soft closing	Code Push-to-open
250	BBD250F45RP	BBP250F45RP
300	BBD300F45RP	BBP300F45RP
350	BBD350F45RP	BBP350F45RP
400	BBD400F45RP	BBP400F45RP
450	BBD450F45RP	BBP450F45RP
500	BBD500F45RP	BBP500F45RP
550	BBD550F45RP	BBP550F45RP
600	-	BBP600F45RP
650	-	BBP650F45RP
700	-	BBP700F45RP

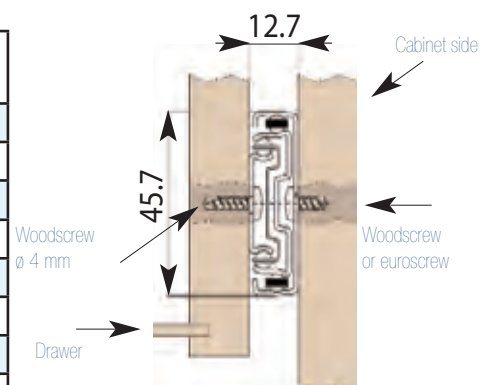

## Ball bearing slides h 45 mm, full extension standard



Cabinet profile and drawer profile must be separated when mounting. Expand slide, place it on its side and pull black lever as shown in order to separate the profiles.  
Slide the two profiles into the respective wood parts.  
Mount the drawer by inserting profiles inside one another.

- Mounting on drawer side
- Separable cabinet and drawer profiles for mounting
- Guiding double tracks, stop in opening
- Load capacity 45 kg per set

Drawer lengths	Code
250	BBN250F45RP
300	BBN300F45RP
350	BBN350F45RP
400	BBN400F45RP
450	BBN450F45RP
500	BBN500F45RP
550	BBN550F45RP
600	BBN600F45RP
650	BBN650F45RP
700	BBN700F45RP
750	BBN750F45RP
800	BBN800F45RP
850	BBN850F45RP
900	BBN900F45RP

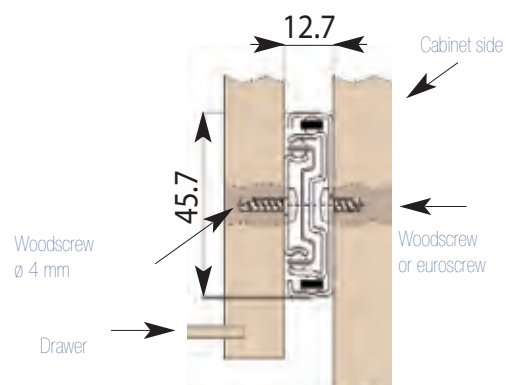

## Ball bearing slides h 35 mm, partial extension

- Mounting on drawer side
- Separable cabinet and drawer profiles for mounting
- Stop in opening, guiding double tracks
- Lateral drilling centers 32 mm
- Load capacity 18 kg per set
- Zinc coating - more finishings available on request



Cabinet profile and drawer profile must be separated when mounting. Expand slide, place it on its side and pull black lever as shown in order to separate the profiles. Slide the two profiles into the respective wood parts. Mount the drawer by inserting profiles inside one another.

Drawer lengths	Code
250	BBN250S35RP
300	BBN300S35RP
350	BBN350S35RP
400	BBN400S35RP
450	BBN450S35RP
550	BBN550S35RP
550	BBN550S35RP
600	BBN600S35RP

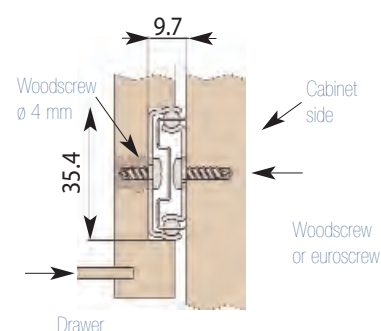

## Ball bearing slides h 27 mm, partial extension

- Mounting in a milled hole of 27 mm in the drawer side
- Single extension, guiding double tracks, stop in opening
- Side holes position centers 32 mm
- Load capacity: 15 kg per set
- Zinc coating - more finishings available on request
- h 17 mm version available on request

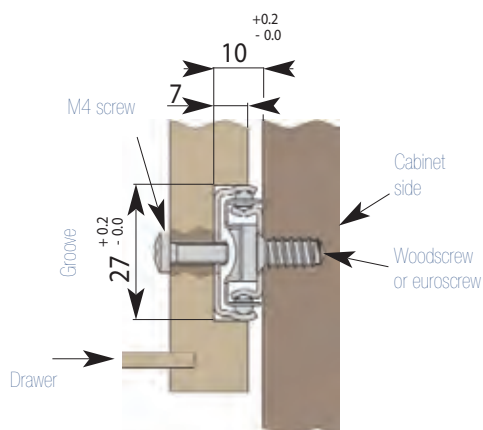

Drawer lengths (min/max)		Code
182	290	BBN182S27RP
214	355	BBN214S27RP
246	415	BBN246S27RP
278	480	BBN278S27RP
310	545	BBN310S27RP
342	580	BBN342S27RP
374	650	BBN374S27RP
406	715	BBN406S27RP
438	775	BBN438S27RP



## Self-closing slides

- Bottom mounting self-closing slides with drawer side adjustment
- Rollers and slide rails of special design for silent sliding
- Load capacity: 25 kg
- Untoxic epoxy finish
- Steel thickness from 0.8 to 1.2 mm
- 50mm self-closing length.
- Available lengths: mm 250, 300, 350, 400, 450, 500, 550, 600.
- Available colors: white RAL 9001, black RAL 9005, brown RAL 8017, grey RAL 7004
- Available packing: industrial, single set.
- Available Relax optional soft closing



E. Patent: 0 688 520  
U.S. Patent: 5.626.450

Cam for slide adjustment

Self-closing system

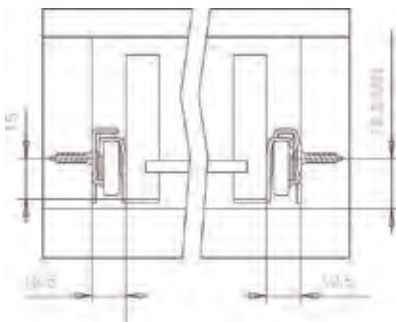

## Lift slides

- Vertical adjustment system
- Fastening to cabinet side with two Ø 10mm dowels
- The front dowel premounted at 37mm for side adjustment  $\pm 1$ mm of slide
- It allows a perfect drawer alignment once the piece of furniture is assembled
- Fasten the slide with an additional screw in the shown position
- Available lengths: mm 250, 300, 350, 400, 450, 500, 550, 600.
- Available colors: white RAL 9001, black RAL 9005, brown RAL 8017, grey RAL 7004
- Available packing: industrial, single set.

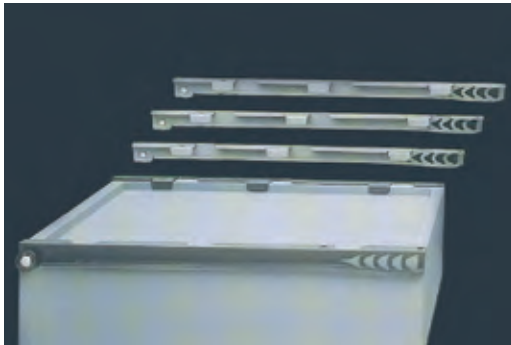

## CLAMP self-closing slides

- Self-closing slides with drawer side adjustment
- The CLAMP fastening is achieved by pressing 3 brackets into the drawer panels
- It allows a quick fastening without screws
- The drawer slide is held uniformly along the length of the drawer side
- Slides available with LIFT adjustment
- Available lengths: mm 250, 300, 350, 400, 450, 500, 550, 600.
- Available colors: white RAL 9001, black RAL 9005, brown RAL 8017, grey RAL 7004
- Available packing: industrial, single set.

CLAMP system

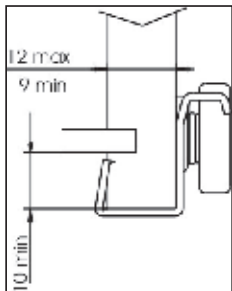

Roller drawer slides drilling pattern

T = Standard dowel position

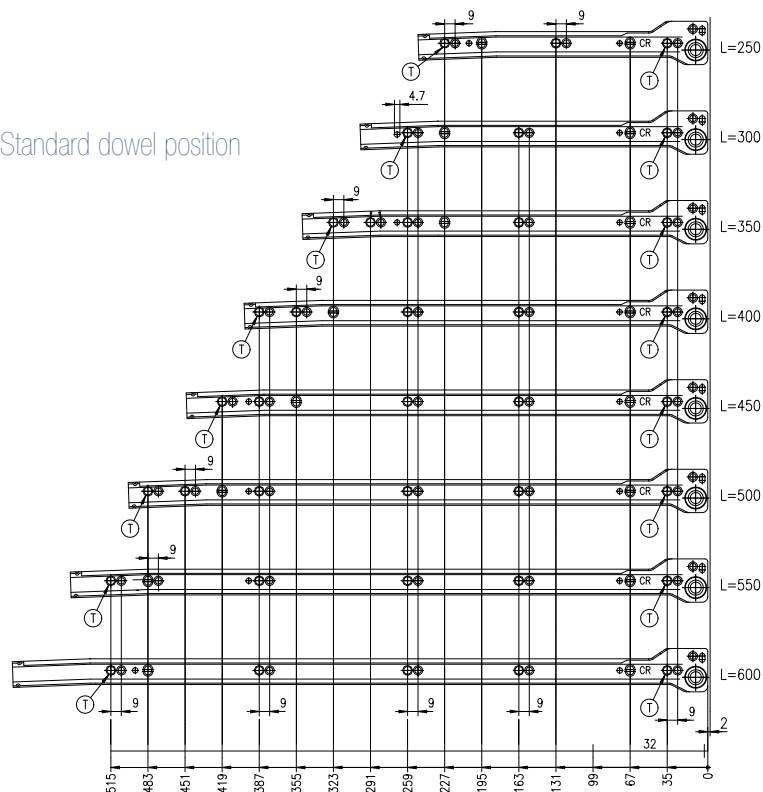

FAST 3 / FAST 4  
Pneumatic bending machine for  
drawer mass production.  
E. Patent: 0 674 968 U.S.  
Patent: 5.535.504



FAST 8  
Pneumatic tool for any  
production.  
E. Patent: 0 742 060 U.S.  
Patent: 5.737.820

[illegible]





#### ITALY

Ferrari Point srl  
Via E. Fermi, 4 - Loc. Olmi  
I-31048 S. Biagio di Callalta (TV) - Italy  
Tel.: +39 0422 892389  
Fax: +39 0422 892296

#### AMERICA

Ferrari America Inc.  
4189 Eagle Hill Driver Suite 110  
27265 High Point - North Carolina USA  
Tel.: +1 336 8411445  
Fax: +1 336 8413543  
Web: [www.ferrariamerica.com](http://www.ferrariamerica.com)  
e-mail: [info@ferrariamerica.com](mailto:info@ferrariamerica.com)

#### CHINA

Ferrari Shunde R.O  
New world China Land Shunde 15D  
NO.148 Qinghui Road  
Daliang Shunde 528308  
FoShan China  
Tel.: +86 757 22306761-2

#### GERMANY

Agostino Ferrari Germany GmbH  
Höferweg 22  
32602 Vlotho - Germany  
Tel. +49 5733 877970  
Fax. +49 5733 8779710  
Web: [www.ferrari-fittings.de](http://www.ferrari-fittings.de)  
e-mail: [ferrari@ferrari-fittings.de](mailto:ferrari@ferrari-fittings.de)

#### SLOVAKIA

A. Ferrari Sk, s.r.o.  
Levočská 3013/50  
05801 Poprad Slovakia  
Tel.: +421 52 7722105  
Fax: +421 52 7793900

Each Ferrari's product is constantly improved according to all market technical requirements and proposals. Ferrari holds the right to alter or amend without notice any technical or structural specifications at any time. Ferrari cannot be held responsible for any usage other than that advise in the catalogue. If particular application is needed which is not in the recommended tables, we suggest to contact Ferrari Technical Department. Products sheet are available on demand.



Copyright Ferrari. Subject to technical modifications and changes to the range without notice.

15ENG02  
Printed in Italy

#### A. Ferrari SpA

23879 Verderio (LC) - Italy  
Via per Cornate, 45  
Tel: +39 039 59 00  
Fax: +39 039 59 00 222

[www.ferrarispa.it](http://www.ferrarispa.it)  
e-mail: [ferrarispa@ferrarispa.it](mailto:ferrarispa@ferrarispa.it)

